

# 130' CREW/FSV SEABULK LAFOURCHE



130' CREW/FSV SEABULK LAFOURCHE

## MAIN PARTICULARS

LENGTH OVERALL	130 ft.	40 m
LENGTH BP		
BEAM	26 ft.	8 m
DEPTH	12 ft.	
LIGHT DRAFT	7 ft.	
LOADED DRAFT	9 ft.	3 m
SUMMER FREEBOARD		
LIGHTSHIP		

## CAPACITIES

DRILL WATER	
POTABLE WATER	1,200 USG
FUEL	8,055 USG
DRY BULK	
BASE OIL	
DEADWEIGHT	

## CARGO DECK

TONNAGE
STRENGTH
LENGTH
WIDTH
CLEAR AREA

## TONNAGE

GRT	199 US tons
NRT	59 US tons

## MACHINERY

MAIN ENGINES	(4) 12V 92 TA
BRAKE HORSEPOWER	2720
REDUCTION GEARS	
GEAR RATIO	2.5:1
RUDDERS	
PROPELLERS	
AUXILIARY GENERATORS	(2) 30 KW / (2) 371
BOW THRUSTER	
FUEL-OIL PURIFIER	

## PERFORMANCE

MAXIMUM SPEED	24 knots
CRUISING SPEED	
MAXIMUM FUEL CONSUMPTION	100 USG/Hr
CRUISING FUEL CONSUMPTION	

## DISCHARGE RATES

DRILL WATER
FUEL
POTABLE WATER

## ACCOMODATIONS

CABINS/BERTHS	
OFFICERS	
CREW	
VIP	
PASSENGERS	70
LOUNGE	
MESS	

## ELECTRONICS & CONTROLS

DEPTH SOUNDER	International Offshore
GMDSS	
GPS	Sitex XJ-2
RADAR(S)	(1) Furuno 1931 48 Mile, (1) RaytheoRasterscan/R71
VHF	(2) Motorola Triton II
SSB	(1) Sea 222 SSB & Neocoder
INTERNET E-MAIL	
WEATHER RADIO	XM

## SPECIAL EQUIPMENT

EXTERNAL FIFI
NUMBER OF MONITORS

## DOCUMENTATION

CLASS	No
FLAG	USA
SOLAS	
USCG	
YEAR BUILT	1991
BUILDER	Breaux Brothers

This specification is preliminary and subject to change without notice. Exact tank capacities, deadweight, deck cargo capacity and other figures that have been calculated and may change when the actual vessel is delivered.

# 130' CREW/FSV SEABULK LAFOURCHE



130' CREW/FSV SEABULK LAFOURCHE

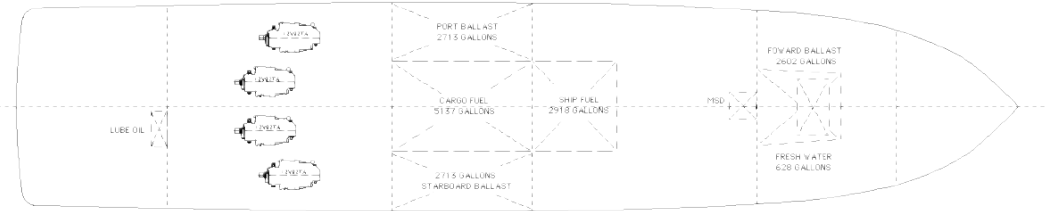
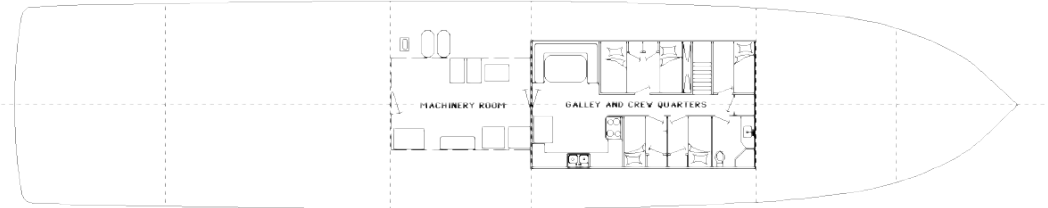
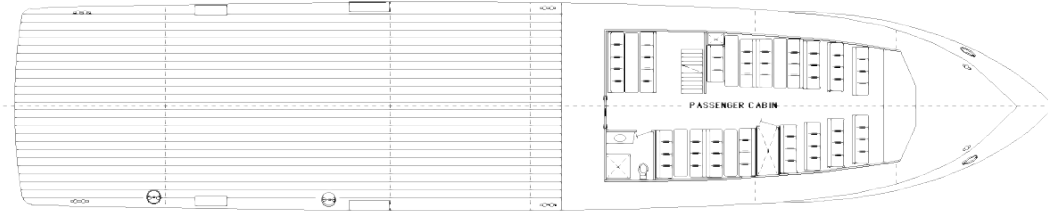
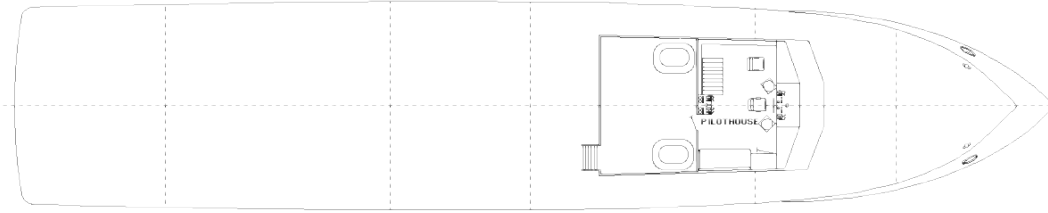

**LENGTH** 130'  
**BEAM** 25'  
**DEPTH** 11'-6"

DECK CARGO 97 TONS  
 TOTAL FUEL 9055 GAL  
 TOTAL WATER 8028 GAL  
 TOTAL FRESH WATER 628 GAL

PROPULSION FOUR 12V92TA ENGINES  
 FIRE PUMP 3-1/2" ENGINE WITH HALF FIRE PUMP  
 U.S.C.G. CERTIFIED FOR 73 PASSENGERS  
 200 PILLS OFF SHORE

