

145' CREW/FSV CAROL ANN McCALL



145' CREW/FSV CAROL ANN McCALL

MAIN PARTICULARS

LENGTH OVERALL	44.83 M	147.08 FT.
LENGTH BP	8.53 M	28.00 FT.
DEPTH	3.56 M	11.67 FT.
DRAFT LOADED	1.86 M	6.10 FT.
SUMMER FREEBOARD	1.70 M	5.57 FT.
LIGHT SHIP	111 MT.	109 LT.

CAPACITIES

FUEL	69 m ³	18,100 USG
DRILL WATER	---	---
POTABLE WATER	135 m ³	35,700 USG
DRY BULK	---	---
BASE OIL	---	---
DEADWEIGHT	265 MT.	260 LT.

CARGO DECK

TONNAGE	244 MT.	240 LT.
STRENGTH	1.5T/m ²	
LENGTH	25 M	83 FT.
WIDTH	7 M	23 FT.
CLEAR AREA	177 m ²	1,909 ft ²

TONNAGE

GRT	297 TONS (ITC)	99 US TONS
NRT	89 TONS (ITC)	67 US TONS

MACHINERY

MAIN ENGINES	5 X CUMMINS KT 19M X 650 BHP each	
BRAKE HORSEPOWER	3,250 BHP	
REDUCTION GEARS	---	
GEAR RATIO	---	
RUDDERS	---	
PROPELLERS	5	
AUXILIARY GENERATORS	2 X 50 KW	
BOW THRUSTER	---	

PERFORMANCE

MAX. SPEED	17 KNOTS	
CRUISING SPEED	15 KNOTS	
MAXIMUM FUEL CONSUMPTION	16 m ³ / 24HRS	176 USG/HR
CRUISING FUEL CONSUMPTION	14 m ³ / 24HRS	154 USG/HR

DISCHARGE RATES

FUEL	20 m ³ /HR @ 30M	90 USG/MIN @100FT
DRILL WATER	---	---
POTABLE WATER	136 m ³ /HR @ 40M	600USG/MIN @ 130FT

ACCOMMODATION

CABINS/BERTHS	4/8
VIP	---
PASSENGERS	82 BENCH CLASS
LOUNGE	---
MESS	8
BUSINESS SEATS	---

ELECTRONICS AND CONTROLS

DEPTH SOUNDER	1 - DATAMARINE DIGITAL
GMDSS	---
GPS	1 - FURUNO
RADAR(S)	SIMRATE AP-35 AUTOPILOT
SSB	2 X FURUNO COLOR T
VHF	2
SSB	1
INTERNAL E-MAIL	GLOBE WIRELESS
CSP MONITORING	---
WEATHER RADIO	---

SPECIAL EQUIPMENT

EXTERNAL FiFi	1 x 900 GPM / 204 m ³ /HR
NUMBER OF MONITORS	1
RIDE CONTROL	---

DOCUMENTATION

CLASS	IS CLASS
FLAG	TUVALU
YEAR BUILT	1997

This specification is preliminary and subject to change without notice. Exact tank capacities, deadweight, deck cargo capacity and other figures that have been calculated and may change when the actual vessel is delivered.

145' CREW/FSV CAROL ANN McCALL



145' CREW/FSV CAROL ANN McCALL

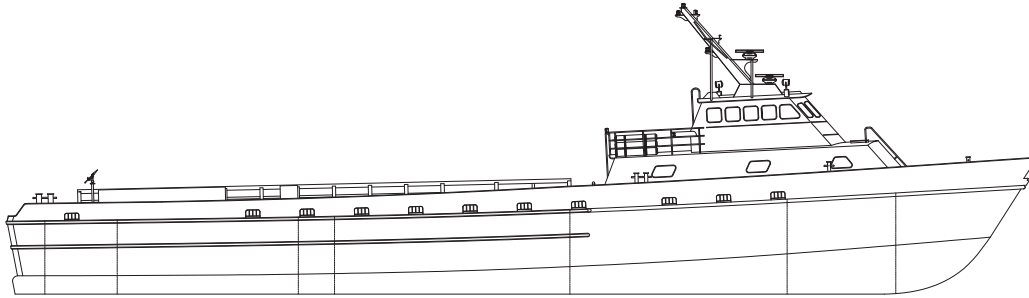

PROFILE

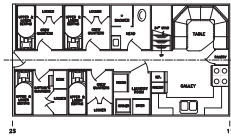

BELOW DECK PLAN

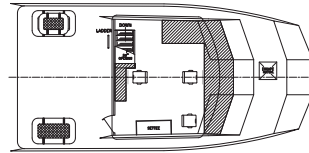

PILOT HOUSE PLAN

